



HRT-7000 Instrument Table

HUVITZ
Refraction Table HRT-7000

Advanced Refraction Table



Handle Design

Ergonomic design with unique handle mechanism to facilitate the movement of upper table with extreme ease.



Power Arm

45° soft movement and up and down multi-sequence adjustment will enable to accommodate any patient comfortably.

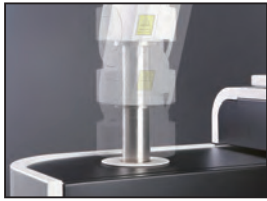

Up & Down Function

Up & Down feature is added in order to provide convenience for measuring position of patients' eyes.



Keypad

Visible Location of Keypads enables you to control the power arm and chair precisely with ease.

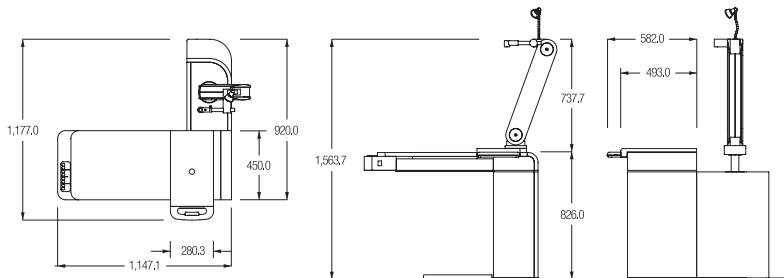

Dimensions	1147mm (W) x 1177mm (D) x 1564mm (H)	
Table Size	1147mm (W) x 450mm (D) x 30mm (T)	
Table Rotating Angle	90°	
Head Stroke	400mm (R-L)	
Power Arm Up-Down Range	±100mm	
Chair Up-Down Range	150mm	
Lamp	LED Lamp 3W	
Power Supply	Supply	AC 110/220V, 50/60Hz
	Consumption	420W (Max)

Technical Specifications